

NEW

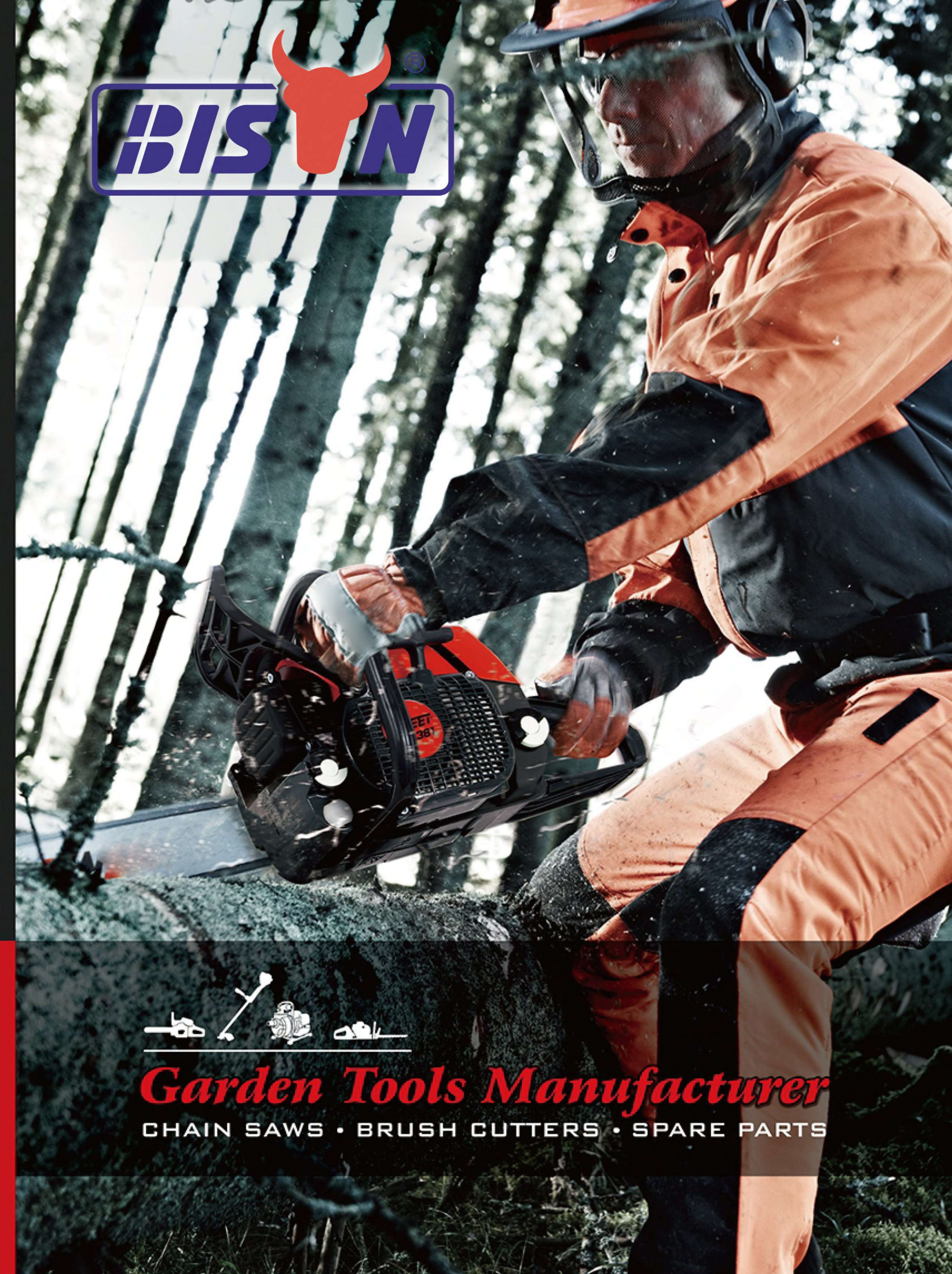

TAIZHOU BISON MACHINERY CO.,LTD.

Add:Build D, No.1515 Fengnan East Road,jiaoJiang,Taizhou City, Zhejiang

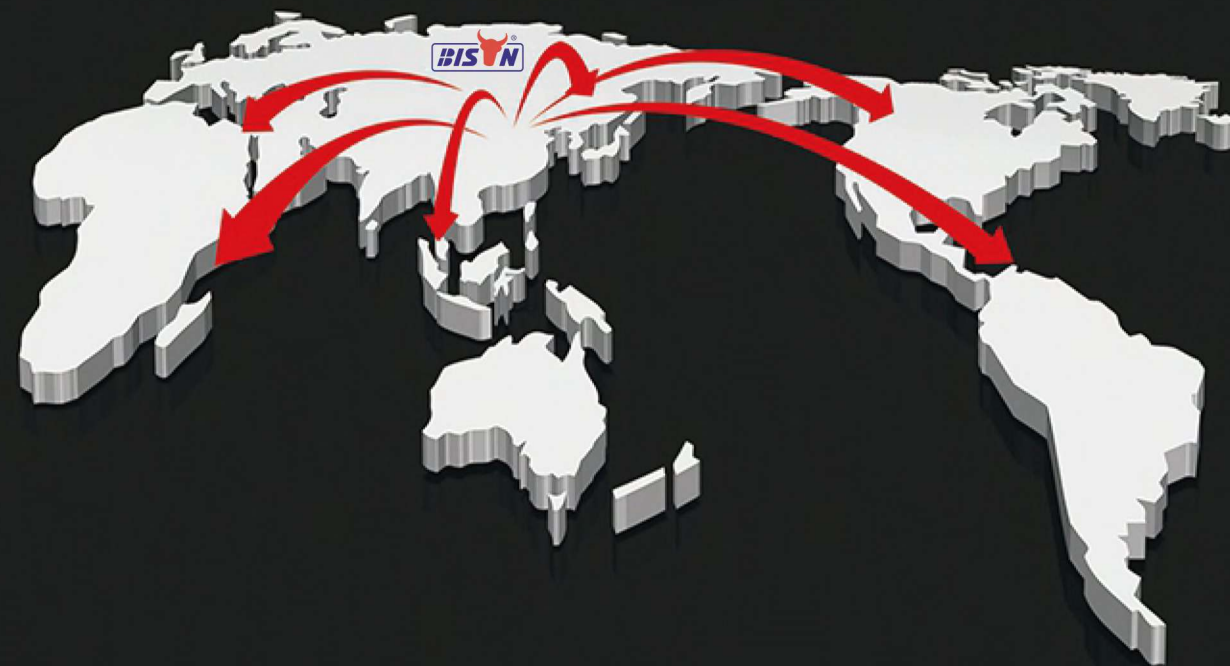

Garden Tools Manufacturer

CHAIN SAWS • BRUSH CUTTERS • SPARE PARTS

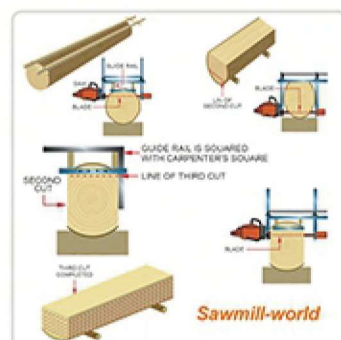

MOD.Sawmill



SAWMILL
 Maximum cutting thickness 150mm
 Maximum cutting diameter 750mm
 Net weight 8KG
 Color Box Size 1000x300x80mm



MOD.070



Model	Sawmill	070
Engine type	2 Stroke	2 Stroke
Displacement	105.7cc	105.7cc
Rated Output Power&Relevant Speed	4.8kw/8000rpm	4.8kw/8000rpm
Fuel Mixture Ratio	25/1(Gasoline 25: Two-cycle Oil 1)	25/1(Gasoline 25: Two-cycle Oil 1)
Fuel Tank Capacity	1200ml	1200ml
Engine Oil Tank Capacity	530ml	530ml
Guide Bar	25" 30"	30" 36" 42"
Chain Pitch	0.404"	0.404"
Chain Gauge	0.063"	0.063"
Net Weight	10.7kg	10.7kg
Color Box Size	535x315x325mm	535x315x325mm



Model	066	382
Engine type	2 Stroke	2 Stroke
Displacement	91.6cc	72.2cc
Rated Output Power&Relevant Speed	5.2kw/9300rpm	3.3kw/7500rpm
Fuel Mixture Ratio	25/1(Gasoline 25: Two-cycle Oil 1)	25/1(Gasoline 25: Two-cycle Oil 1)
Fuel Tank Capacity	680ml	680ml
Engine Oil Tank Capacity	360ml	360ml
Guide Bar	24" 30"	20" 24"
Chain Pitch	3/8"	3/8"
Chain Gauge	0.058"	0.063"
Net Weight	7kg	6.7kg
Color Box Size	480x290x330cm	450x260x300mm



Model	380/381	250
Engine type	2 Stroke	2 Stroke
Displacement	72.2cc	45.5cc
Rated Output Power&Relevant Speed	3.3kw/7500rpm	2.3kw/9500rpm
Fuel Mixture Ratio	25/1(Gasoline 25: Two-cycle Oil 1)	25/1(Gasoline 25: Two-cycle Oil 1)
Fuel Tank Capacity	680ml	470ml
Engine Oil Tank Capacity	360ml	200ml
Guide Bar	20" 24"	16" 18"
Chain Pitch	3/8"	3/8"
Chain Gauge	0.063"	0.050"
Net Weight	6.7kg	5kg
Color Box Size	450x260x300mm	440x260x285mm



Model	4000
Engine type	2 Stroke
Displacement	39.6cc
Rated Output Power&Relevant Speed	1.5kw/11000rpm
Fuel Mixture Ratio	25/1(Gasoline 25: Two-cycle Oil 1)
Fuel Tank Capacity	410ml
Engline Oil Tank Capacity	240ml
Guide Bar	16"
Chain Pitch	3/8"
Chain Gauge	0.050"
Net Weight	4.3kg
Color Box Size	470x250x330mm



Model	4200ES
Engine type	2 Stroke
Displacement	39.6cc
Rated Output Power&Relevant Speed	1.5kw/11000rpm
Fuel Mixture Ratio	25/1(Gasoline 25: Two-cycle Oil 1)
Fuel Tank Capacity	410ml
Engline Oil Tank Capacity	240ml
Guide Bar	16"
Chain Pitch	3/8"
Chain Gauge	0.050"
Net Weight	4.3kg
Color Box Size	470x250x330mm



Model	5200
Engine type	2 Stroke
Displacement	49.3cc
Rated Output Power&Relevant Speed	2.0kw/7500rpm
Fuel Mixture Ratio	25/1(Gasoline 25: Two-cycle Oil 1)
Fuel Tank Capacity	550ml
Engline Oil Tank Capacity	260ml
Guide Bar	18" 20" 22"
Chain Pitch	0.325" 3/8"
Chain Gauge	0.058" 0.063"
Net Weight	6.0kg
Color Box Size	490x260x300mm



Model	5800
Engine type	2 Stroke
Displacement	54.6cc
Rated Output Power&Relevant Speed	2.2kw/7500rpm
Fuel Mixture Ratio	25/1(Gasoline 25: Two-cycle Oil 1)
Fuel Tank Capacity	550ml
Engline Oil Tank Capacity	260ml
Guide Bar	18" 20" 22"
Chain Pitch	0.325" 3/8"
Chain Gauge	0.058" 0.063"
Net Weight	6.0kg
Color Box Size	490x260x300mm



Model	268
Engine type	2 Stroke
Displacement	69cc
Rated Output Power&Relevant Speed	3.2kw/7500rpm
Fuel Mixture Ratio	25/1(Gasoline 25: Two-cycle Oil 1)
Fuel Tank Capacity	750ml
Engline Oil Tank Capacity	450ml
Guide Bar	20" 24"
Chain Pitch	3/8"
Chain Gauge	0.063"
Net Weight	6.0kg
Color Box Size	480x265x315mm



Model	180
Engine type	2 Stroke
Displacement	31.8cc
Rated Output Power&Relevant Speed	1.5kw/9500rpm
Fuel Mixture Ratio	25/1(Gasoline 25: Two-cycle Oil 1)
Fuel Tank Capacity	250ml
Engline Oil Tank Capacity	145ml
Guide Bar	14" 16"
Chain Pitch	3/8"
Chain Gauge	0.050"
Net Weight	3.9kg
Color Box Size	380x250x280mm

Chain Saw



Brush Cutter



Model	2500	3600
Engine type	2 Stroke	2 Stroke
Displacement	25.4cc	25.4cc
Rated Output Power&Relevant Speed	1.0kw/7500rpm	1.0kw/7500rpm
Fuel Mixture Ratio	25/1(Gasoline 25: Two-cycle Oil 1)	25/1(Gasoline 25: Two-cycle Oil 1)
Fuel Tank Capacity	230ml	260ml
Engline Oil Tank Capacity	160ml	180ml
Guide Bar	10" 12" 14"	10" 12" 14"
Chain Pitch	3/8"	3/8"
Chain Gauge	0.043"/0.050"	0.043"/0.050"
Net Weight	3.2kg	3.2kg
Color Box Size	310x250x230mm	310x250x230mm



Model	CX35	BG35
Engine	1E140F	1E140F
Engine type	Single Cylinder,Air Cooled, 4 Stroke	Single Cylinder,Air Cooled, 4 Stroke
Max power	1.0kw	1.0kw
Displacement	35.8cc	35.8cc
Carburetor Type	Diaphragm type	Diaphragm type
Fuel Tank	1000ml	1000ml
G.W/N.W Engine	4.3kg	4.7kg
G.W/N.W Shaft	2.8kg	3.2kg
Packing Size Engine	315x300x225mm	330x310x405mm
Packing Size Shaft	1650x100x100mm	1500x100x100mm



Model	3900
Engine type	2 Stroke
Displacement	25.4cc
Rated Output Power&Relevant Speed	1.0kw/7500rpm
Fuel Mixture Ratio	25/1(Gasoline 25: Two-cycle Oil 1)
Fuel Tank Capacity	230ml
Engline Oil Tank Capacity	160ml
Guide Bar	10" 12" 14"
Chain Pitch	3/8"
Chain Gauge	0.043"/0.050"
Net Weight	3.2kg
Color Box Size	310x250x230mm



Model	BG35H
Engine	1E140F
Engine type	Single Cylinder,Air Cooled, 4 Stroke
Max power	1.0kw
Displacement	35.8cc
Carburetor Type	Diaphragm type
Fuel Tank	1000ml
G.W/N.W Engine	4.2kg
G.W/N.W Shaft	3.4kg
Packing Size Engine	355x310x540mm
Packing Size Shaft	1500x100x100mm



Model	CG139B	CG139HS
Engine	1E139F	1E139F
Engine type	Single Cylinder,Air Cooled, 4 Stroke	Single Cylinder,Air Cooled, 4 Stroke
Max power	0.75kw	0.75kw
Displacement	31cc	31cc
Carburetor Type	Diaphragm type	Diaphragm type
Fuel Tank	1000ml	1000ml
G.W/N.W Engine	4.3kg	4.3kg
G.W/N.W Shaft	2.8kg	2.8kg
Packing Size Engine	330x230x330mm	330x230x330mm
Packing Size Shaft	1650x100x100mm	1650x100x100mm



Model	CX25	GX50
Engine	GX25	G50
Engine type	Single Cylinder,Air Cooled, 2 Stroke	Single Cylinder,Air Cooled, 2 Stroke
Max power	0.72kw	1.47kw
Displacement	25cc	47.9cc
Carburetor Type	Diaphragm type	Diaphragm type
Fuel Tank	530ml	630ml
G.W/N.W Engine	3.5kg	4.2kg
G.W/N.W Shaft	3.2kg	3.2kg
Packing Size Engine	320x300x225mm	330x230x330mm
Packing Size Shaft	1650x100x100mm	1650x100x100mm



Model	CG139	BG139
Engine	1E139F	1E139F
Engine type	Single Cylinder,Air Cooled, 4 Stroke	Single Cylinder,Air Cooled, 4 Stroke
Max power	0.75kw	0.75kw
Displacement	31cc	31cc
Carburetor Type	Diaphragm type	Diaphragm type
Fuel Tank	1000ml	1000ml
G.W/N.W Engine	4.3kg	4.7kg
G.W/N.W Shaft	2.8kg	3.2kg
Packing Size Engine	330x230x330mm	330x240x360mm
Packing Size Shaft	1650x100x100mm	1500x100x100mm



Model	CG260	CG330
Engine	1E34F	1E36F
Engine type	Single Cylinder,Air Cooled, 2 Stroke	Single Cylinder,Air Cooled, 2 Stroke
Max power	0.7kw	0.9kw
Displacement	25.4cc	33cc
Carburetor Type	Diaphragm type	Diaphragm type
Fuel Tank	1000ml	1000ml
G.W/N.W Engine	3.5kg	4.7kg
G.W/N.W Shaft	3.2kg	3.2kg
Packing Size Engine	320x300x200mm	330x230x330mm
Packing Size Shaft	1650x100x100mm	1650x100x100mm



Model	CG430	CG430
Engine	1E40-5	1E40-5
Engine type	Single Cylinder,Air Cooled, 2 Stroke	Single Cylinder,Air Cooled, 2 Stroke
Max power	1.25kw	1.25kw
Displacement	42.7cc	42.7cc
Carburetor Type	Diaphragm type	Diaphragm type
Fuel Tank	1200ml	1200ml
G.W/N.W Engine	4.7kg	4.3kg
G.W/N.W Shaft	3.2kg	2.2kg
Packing Size Engine	320x230x320mm	320x230x320mm
Packing Size Shaft	1650x100x100mm	1650x100x100mm



Model	411-L	411-R
Engine	1E40-6	1E40-6
Engine type	Single Cylinder,Air Cooled, 2 Stroke	Single Cylinder,Air Cooled, 2 Stroke
Max power	1.4kw	1.4kw
Displacement	40.2cc	40.2cc
Carburetor Type	Float type	Float type
Fuel Tank	1000ml	1000ml
G.W/N.W Engine	4.7kg	4.3kg
G.W/N.W Shaft	3.2kg	2.2kg
Packing Size Engine	320x300x220mm	320x300x220mm
Packing Size Shaft	1650x100x100mm	1650x100x100mm

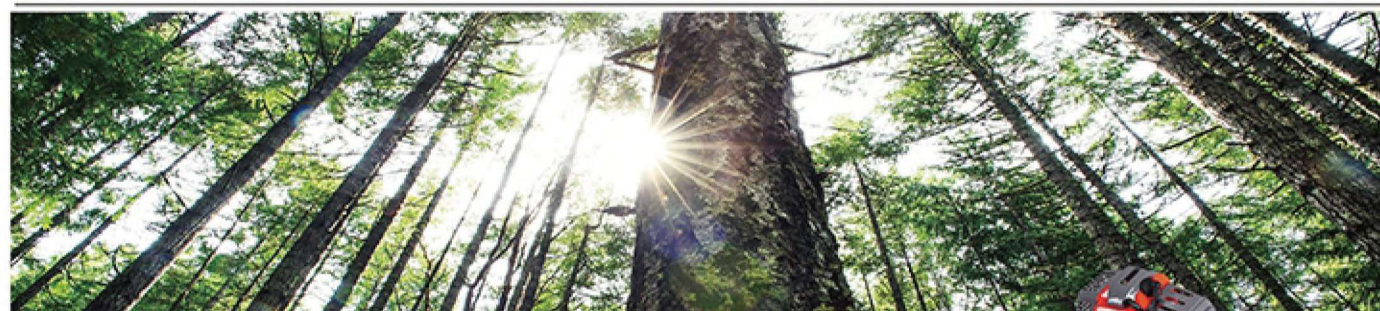

Model	CG430 4 in 1
Engine	1E34F/36F/40F-5
Engine type	Single Cylinder,Air Cooled, 2 Stroke
Max power	1.25kw
Displacement	42.7cc
Carburetor Type	Diaphragm type
Fuel Tank	700ml
G.W/N.W Engine	4.3kg
Packing Size Engine	1080x290x280(130)mm



Model	WP330	WP430	WP35
Engine	1E36F	1E40-5	1E140F
Engine type	2 Stroke	2 Stroke	4 Stroke
Max power	0.9kw	1.25kw	1.0kw
Displacement	33cc	42.7cc	35.8cc
Carburetor Type	Diaphragm type	Diaphragm type	Diaphragm type
Fuel Tank	1200ml	1200ml	1000ml
Diameter	1"	1.5"	1"
Suction head	7m	7m	7m
Pump lift	26m	26m	26m
Packing Size	445x295x345mm	445x295x345mm	445x295x345mm



Description	BS430
Engine	1E40FG
Engine type	2-stroke air cooled
Displacement(ml)	42.7
Power(kw/rpm)	1.25/6500
Idle speed(rpm±200)	2800
Noise(dba)	≤105
Spark plug	L7T(Torch)
Fuel mix ratio	25:1~40:1
Fuel tank capacity(L)	1.3
Air velocity(m/s)	≥47
Air volume(m3/s)	≥0.4
N.W/G.W(kg)	10.5/11
Style:	Husqvarna
Dimension(mm)	420X335X450
Certificate	CE



Description	BS260A
Engine	1E34F
Engine type	2-stroke air cooled
Displacement(ml)	25.4
Power(kw/rpm)	0.75/7500
Idle speed(rpm±200)	2800
Noise(dba)	≤108
Spark plug	L6
Fuel mix ratio	25:1~40:1
Fuel tank capacity(L)	0.45
Air velocity(m/s)	≥70
Air volume(m3/s)	≥0.2
N.W/G.W(kg)	4.5/5.3
Style:	Husqvarna
Dimension(mm)	420x280x360
Certificate	CE



Description	BS750
Engine	1E48FP
Engine type	2-stroke air cooled
Displacement(ml)	63.3
Power(kw/rpm)	2.7/6800
Idle speed(rpm±200)	2800
Noise(dba)	≤108
Spark plug	L8RTC(Torch)
Fuel mix ratio	25:1~40:1
Fuel tank capacity(L)	1.5
Air velocity(m/s)	≥47
Air volume(m3/s)	≥0.4
N.W/G.W(kg)	10.5/11
Style:	KOMATSU
Dimension(mm)	520X390X570
Certificate	CE



Description	BS9000
Engine	1E49FP
Engine type	2-stroke air cooled
Displacement(ml)	79.3
Power(kw/rpm)	2.7/7000
Idle speed(rpm±200)	2800
Noise(dba)	≤108
Spark plug	L9RTC(Torch)
Fuel mix ratio	40:1~50:1
Fuel tank capacity(L)	2.1
Air velocity(m/s)	≥47
Air volume(m3/s)	≥0.4
N.W/G.W(kg)	10.9/12
Style:	MARUYAMA
Dimension(mm)	375x510x560
Certificate	CE



Model:	BS2300HT
Engine:	Two Stroke
Displacement:	22.5CC
Output Power:	0.6kw/0.8Hp
Fuel Tank:	600ml
Max Cutting Capacity:	22mm
Blade Type:	Double Side
Cutting Length:	600mm



Model:	BS2311HT
Engine:	Two Stroke
Displacement:	22.5CC
Output Power:	0.6kw/0.8Hp
Fuel Tank:	600ml
Max Cutting Capacity:	22mm
Blade Type:	Single Side
Cutting Length:	600mm



Model:	BS4302HTB2
Engine:	Two Stroke
Displacement:	42.7CC
Output Power:	1.25kw/1.6Hp
Fuel Tank:	1000ml
Max Cutting Capacity:	22mm
Blade Type:	Single Blade
Cutting Length:	600mm



Model:	BS5200EAB
Engine:	Two Stroke
Displacement:	51.2CC
Output Power:	1.4kw/1.9Hp
Fuel Tank:	1000ml



Model:	BS5200EAD
Engine:	Two Stroke
Displacement:	51.2CC
Output Power:	1.4kw/1.9Hp
Fuel Tank:	1000ml



Model:	BS5201EAF
Engine:	Two Stroke
Displacement:	51.2CC
Output Power:	1.4kw/1.9Hp
Fuel Tank:	1000ml



Model:	BS6400EAI
Engine:	Two Stroke
Displacement:	63.3CC
Output Power:	2.0kw/2.7Hp
Fuel Tank:	1300ml



Gear Box A



Gear Box B



Gear Box C

Drill Types



Usual Drill

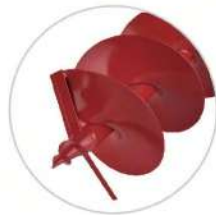

One-piece Drill



Alloy Drill



Round Drill



Ice Drill



Extension Bar

Double Spiral

Single Spiral

Earth Drill Diameter	Drill Depth
80mm	800mm/1000mm
100mm	800mm/1000mm
150mm	800mm/1000mm
200mm	800mm/1000mm
250mm	800mm/1000mm
300mm	800mm/1000mm
400mm	800mm
500mm	800mm

Ice Drill Diameter	Drill Depth
200mm	800mm/1000mm
250mm	800mm/1000mm
300mm	800mm/1000mm



Model:	BS-GT006
Engine:	Two Stroke
Displacement:	51.2CC
Output Power:	1.4kw/1.9Hp
Fuel Tank:	1000ml
Working Width:	300mm
Working Depth:	100-150mm



Model:	BS-GT010
Engine:	Two Stroke
Displacement:	63.3CC
Output Power:	2.0kw/2.7Hp
Fuel Tank:	1300ml
Working Width:	430mm
Working Depth:	150mm



Model:	BS-GT006A
Engine:	Two Stroke
Displacement:	63.3CC
Output Power:	2.0kw/2.7Hp
Fuel Tank:	1300ml
Working Width:	340mm
Working Depth:	30mm



Model:	BS-GT006F
Engine:	Two Stroke
Displacement:	51.2CC
Output Power:	1.4kw/1.9Hp
Fuel Tank:	1000ml
Working Width:	250mm
Working Depth:	90mm



Model:	BS-HPC04
Engine:	Two Stroke
Displacement:	42.7CC
Output Power:	1.25kw/1.6Hp
Fuel Tank:	1000ml
Pole Diameter:	26mm/28mm
Blade:	Metal Blade or Nylon Cutter



Model:	BS-HPC05
Engine:	Two Stroke
Displacement:	42.7CC
Output Power:	1.25kw/1.6Hp
Fuel Tank:	1000ml
Pole Diameter:	26mm/28mm
Blade:	Metal Blade or Nylon Cutter



Model:	BS-HPC06
Engine:	Two Stroke
Displacement:	42.7CC
Output Power:	1.25kw/1.6Hp
Fuel Tank:	1000ml
Pole Diameter:	26mm/28mm
Blade:	Metal Blade or Nylon Cutter



Model:	BS5209WEBA	BS5209WEBB
Engine:	Two Stroke	Two Stroke
Displacement:	51.2CC	51.2CC
Output Power:	1.4kw/1.9Hp	1.4kw/1.9Hp
Fuel Tank:	1000ml	1000ml
Pole Diameter:	26mm/28mm	26mm
Blade:	Weeder	Weeder



BS4301MT-POLE SAW
BS5201MT-POLE SAW



BS4301MT-HEDGE TRIMMER-(1)
BS5201MT-HEDGE TRIMMER-(1)



BS4301MT-WEEDER-(3)
BS5201MT-WEEDER-(3)



BS4301MT-WEEDER-(2)
BS5201MT-WEEDER-(2)



BS4301MT-TILLER-(5)
BS5201MT-TILLER-(5)



BS4301MT-SNOW BLOWER
BS5201MT-SNOW BLOWER

Model:	BS4301MT	BS5201MT
Engine:	Two Stroke	Two Stroke
Displacement:	42.7CC	51.2CC
Output Power:	1.25kw/1.6Hp	1.4kw/1.9Hp
Fuel Tank:	1000ml	1000ml
Pole Diameter:	26mm/28mm	26mm/28mm



Model:	BS5209WECC	BS5209WECB
Engine:	Two Stroke	Two Stroke
Displacement:	51.2CC	51.2CC
Output Power:	1.4kw/1.9Hp	1.4kw/1.9Hp
Fuel Tank:	1000ml	1000ml
Pole Diameter:	26mm	26mm
Blade:	Weeder	Weeder



Model:	BS2600PM	
Engine:	Two Stroke	
Displacement:	25.4CC	
Output Power:	0.7kw/1.0Hp	
Fuel Tank:	730ml	
Pole Diameter:	26mm	
Blade:	Palm Harvester	



070 HIGH QUALITY SPARE PARTS

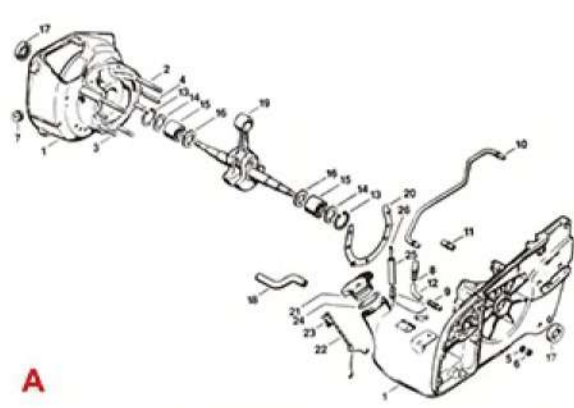

A

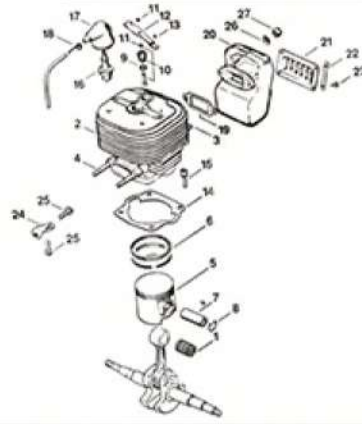

B

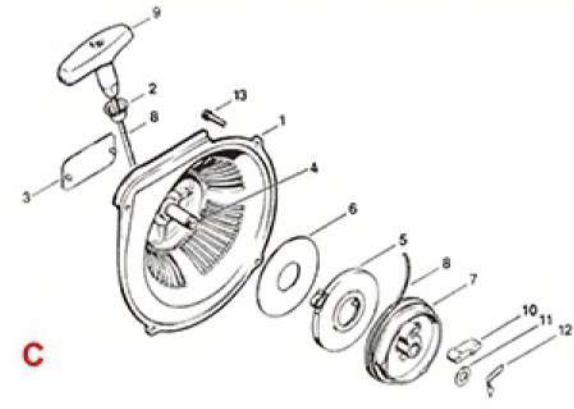

C

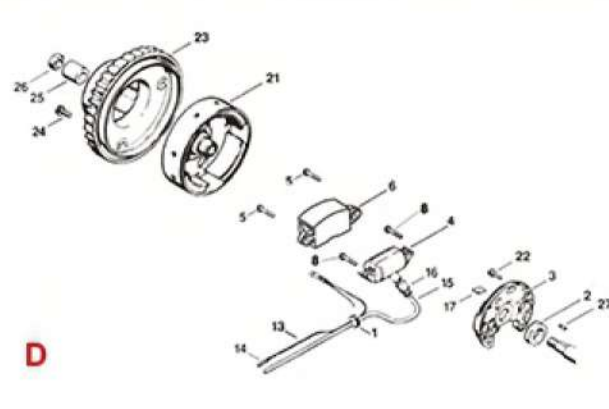

D

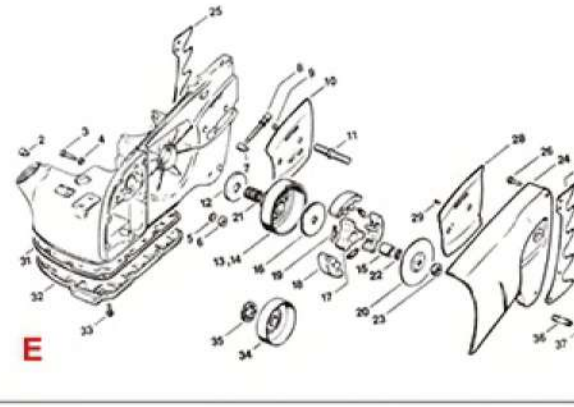

E

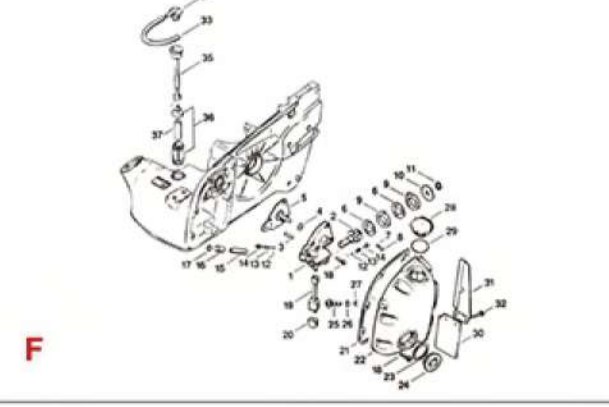

F

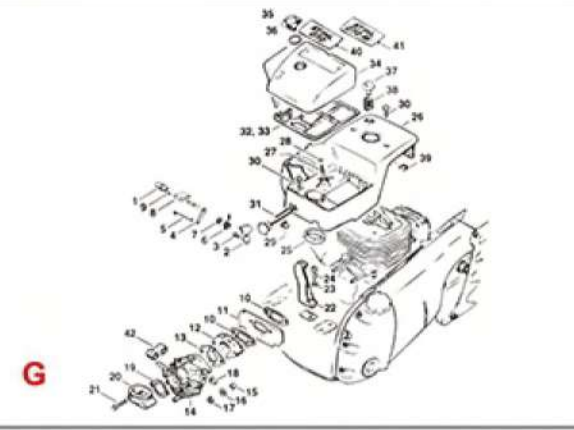

G

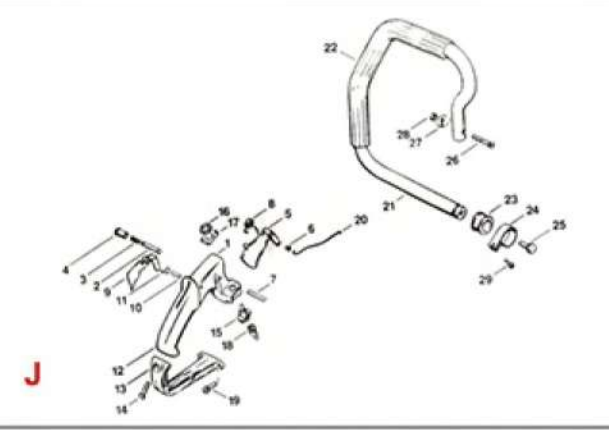

J



070 HIGH QUALITY SPARE PARTS



A1-12

Crankcase



A2

Stud m6x18



A3

Stud m6x35



A8

Connector



A9

Connector



A10

oil line



A15

needle bearing



A15-1

needle bearing



A16

Check plate



A17

oil seal



A18

Tank vent



A19

CRANK SHAFT



A20

gasket



A21-22

FUEL TANK COVER



A25-26

Tank vent



B1

Needle cage



B2-8

Cylinder assy



B2

Cylinder



B3

Stud m6x18



B4

Stud m6x35



B5-8

Piston assy

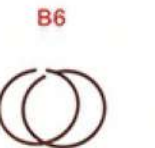

B6

Piston ring



B9-12

Valve



B14

Gasket



B15

Spline screw M6x25



B16

Spark plug



B17-18

Plug terminal assy



B19

Gasket (Muffler)



B20-23

Muffler



B24

Connect plug



C1-12

Starter



C1

Fan housing



C2

Bushinfg

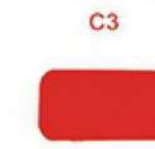

C3

Emblem



C4

Pin



C5

Rewind spring



C6

Washer



C7

Rope rotor



C8

Rope



C9

Grip



C10-12

Pawl+washer+spring



C13

Screw M5x18



D3-16

Flywheel Magneto



D3-19

Magneto Assy



D1

Grommet



D3

Magneto Assy



D4

Staror



D5

Pan Head Screw



D6

CDI staror



D7

Set Of Points



D8

Pan Head Screw



D10

Capacitor



070 HIGH QUALITY SPARE PARTS



070 HIGH QUALITY SPARE PARTS





380/381 HIGH QUALITY SPARE PARTS

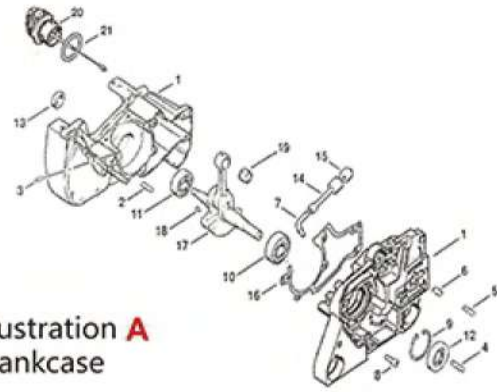

Illustration A
crankcase

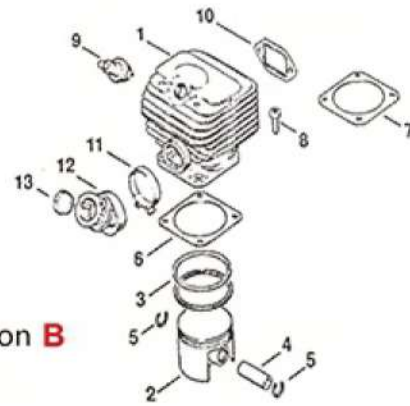

Illustration B
cylinder

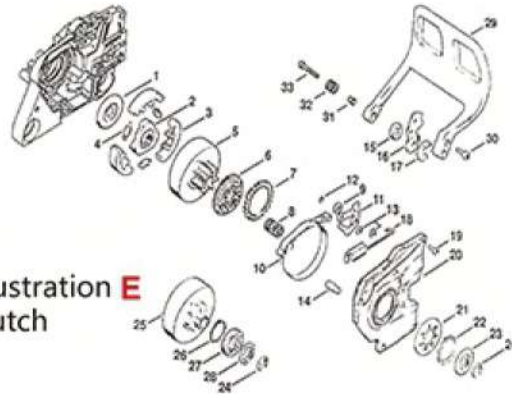

Illustration E
clutch

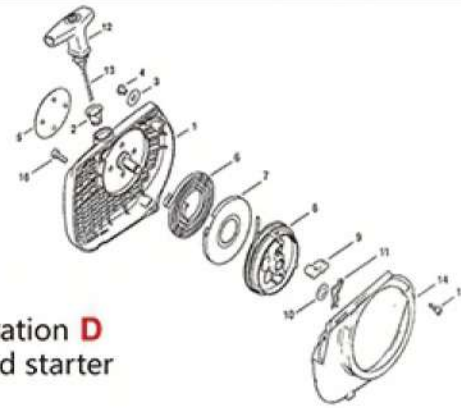

Illustration D
rewind starter

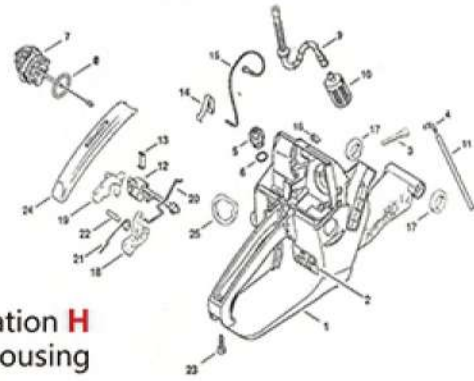

Illustration H
tank housing

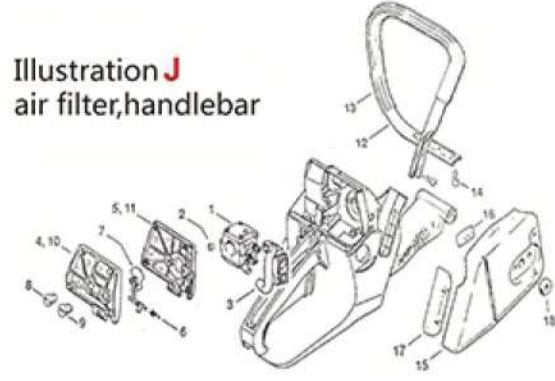

Illustration J
air filter,handlebar

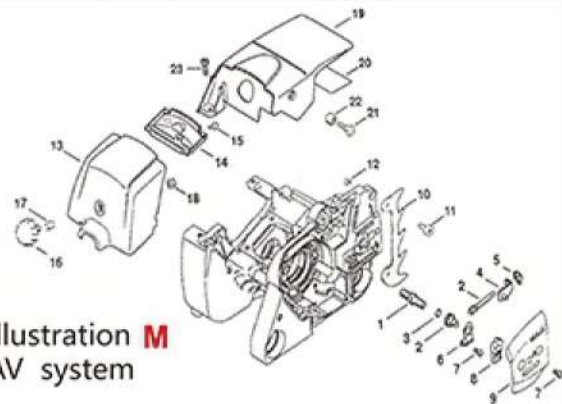

Illustration M
AV system

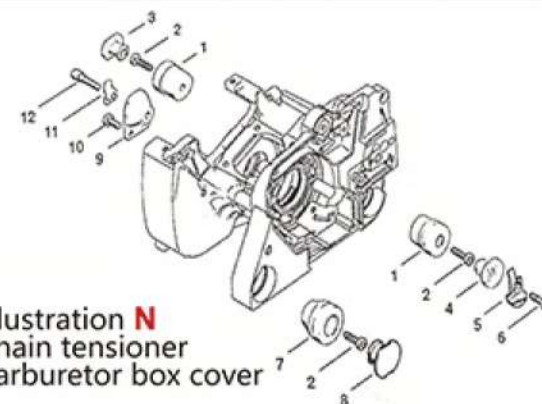
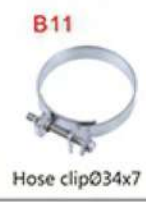

Illustration N
chain tensioner
carburetor box cover



380/381 HIGH QUALITY SPARE PARTS



380/381 HIGH QUALITY SPARE PARTS



380/381 HIGH QUALITY SPARE PARTS





066 HIGH QUALITY SPARE PARTS



066 HIGH QUALITY SPARE PARTS



268 HIGH QUALITY SPARE PARTS



5200 HIGH QUALITY SPARE PARTS



5200 HIGH QUALITY SPARE PARTS



CX35 HIGH QUALITY SPARE PARTS





解剖图



平面图



快速注油孔



纯铜齿轮



锥形轴承



合成级润滑油



A



B

C



W1 大直刀轮 N.W: 4.7kg



W2 中直刀轮 N.W: 4kg



W3 小直刀轮 N.W: 3.4kg



W4 六爪深耕 N.W: 3.4kg



W5 浅耕刀轮 N.W: 4kg



W6 深耕刀轮 N.W: 4.6kg



W7 斜刀轮 N.W: 5kg

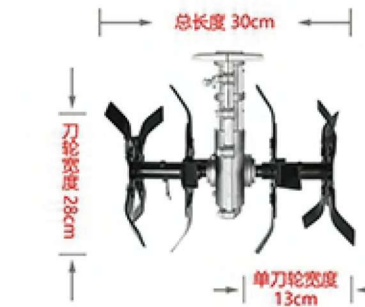

W8 松土轮 N.W: 4.5kg



W9 整平刀轮 N.W: 3kg



W10 防缠草直刀轮 N.W: 4.3kg



W11 开沟刀轮 N.W: 5.15kg



W12 除锈轮 N.W: 9.2kg

Connector Series



C-01

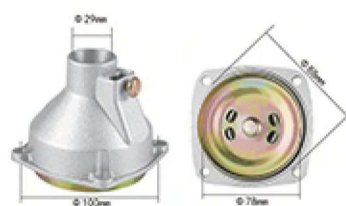

C-02

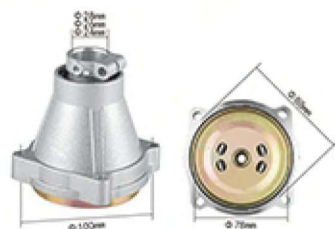

C-03



C-04



C-05



C-06



C-07

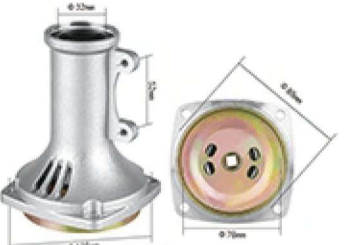

C-08



C-09



C-10



C-11



C-12



C-13



C-14



C-15



C-16

Starter Series



CS-2500



CS-3800



CS-3800-E



CS-4500



CS-5200



CS-5200-E



MS-180



MS-181



MS-250



MS-251



MS-260



MS-290



MS-360



MS-361



MS-038



MS-381



MS-440



MS-660



MS-070



MS-070 REW



HS-137



HS-263



HS-51



HS-350



HS-268



HS-288



HS-365



CS-4000



P-350



CS-6200

Starter Series



 TY-01 名称: 32启动器 32 STARTER	 TY-02 名称: 32易启动器 32 EASY STARTER	 TY-03 名称: 32罗宾启动器 32 STARTER(ROBIN)	 TY-04 名称: 328启动器 328 STARTER
 TY-05 (ROBIN) 名称: 罗宾40-6启动器 1E40-6 STARTER	 TY-06 名称: 34FB易启动器 34FB EASY STARTER	 TY-07 名称: TU26易启动器 Tu26 EASY STARTER	 TY-08 名称: TB26启动器 Tb26 STARTER
 TY-09 名称: 33易启动器 33 EASY STARTER	 TY-10 名称: 34钢丝启动器 34 SS STARTER	 TY-11 名称: 34启动器 34 STARTER	 TY-12 名称: 34易启动器 34 EASY STARTER
 TY-13 名称: 40-5D易启动器B EASY STARTER B	 TY-14 名称: 易启动器C EASY STARTER C	 TY-15 名称: 328易启动器 328 EASYSTARTER	 TY-16 名称: 40多角启动器 40 STARTER
 TY-17 名称: EN328启动器 EN328 STARTER	 TY-18 名称: 川崎TH43启动器 TH43 STARTER (KAWASAKI)	 TY-19 名称: 40启动器 40 STARTER	 TY-20 名称: 40钢丝启动器 40 SS EASY STARTER
 TY-21 名称: 40易启动器B 40 EASY STARTER B	 TY-22 名称: 本田GX35启动器 GX35 STARTER(HONDA)	 TY-23 名称: 本田GX25启动器 GX25 STARTER(HONDA)	 TY-24 名称: 川崎TH34启动器 TH34 STARTER (KAWASAKI)

Guide bar Series



10-1/4-50ST
12-1/4-50ST
14-1/4-50ST
G2500



10", 12" 14"

16-3/8 60D-63ST
18-3/8 66D-63ST



16" 18"

E16,E20,024,026,028 SUPER,030,031,032,034,036,038,040,041,042,044,045,048,056,064,066

16-3/8 50ST
18-3/8 50ST
20-3/8 50ST
22-3/8 50ST
G4500,G5200



16"-22"

20-3/8-72D-63ST
22-3/8-76D-63ST
25-3/8-84D-63ST



20"-25"

041,056,064,066,038,039,041,042,044,046,056,310,380,390,440,460,045,045,064,066

36-404-104D-63ST
33-404-100D-63ST
30-404-92D-63ST
25-404-84D-63ST



25"-36"

07,09,050,051,070,075,076,084,090,E-30,S10

42-404-124D-63ST



42"

CS1100VL,CS1200, 070,090



18"-24"

ONE-PIECE
REPLACABLE
SPROCKET NOSE



16"-20"

FIXED END
ONE-PIECE

